



APPLICATIONS

- Termination of copper or aluminium conductors of Medium Voltage cables

FEATURES

- Tinned aluminium
- Range taking** (multiple sections)
- Adapter for application on smaller cable sizes
- No crimping tool required for installation

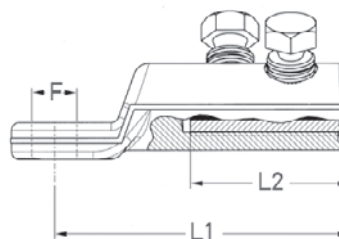
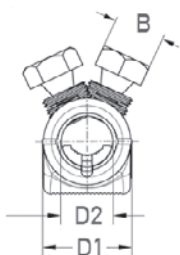

ref.	item	conductor cross-section (mm ²)	hole diameter F (mm)	number contact bolts	size head bolts B (mm)	cable conductor material	dimensions (mm)				min./mult. ord. qty (pcs)
							length L1	ext. diam. D1	length int. L2	int. diam. D2	
CR025095F13	CRMT 25/95-13	25 – 95	13	1	14	Cu, Al	60	24	30	12,8	1
CR035150F13	CRMT 35/150-13	35 – 150	13	1	17	Cu, Al	86	28	35	15,8	1
CR095240F13	CRMT 95/240-13	95 – 240	13	2	19	Cu, Al	112	33	60	20	1
CR095240F17	CRMT 95/240-17	95 – 240	17	2	19	Cu, Al	112	33	60	20	1
CR120300F13	CRMT 120/300-13	120 – 300	13	2	22	Cu, Al	115	37	65	24	1
CR120300F17	CRMT 120/300-17	120 – 300	17	2	22	Cu, Al	115	37	65	24	1
CR185400F13	CRMT 185/400-13	185 – 400	13	3	22	Cu, Al	137	42	80	25,5	1
CR185400F17	CRMT 185/400-17	185 – 400	17	3	22	Cu, Al	137	42	80	25,5	1



APPLICATIONS

- Termination of copper conductors of Medium Voltage cables

FEATURES

- Tin-plated copper
- Double-crimping long body

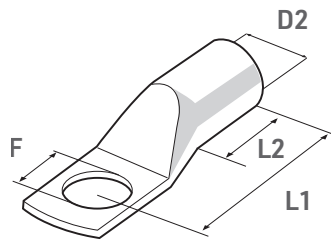

ref.	item	conductor cross-section (mm ²)	hole diameter F (mm)	cable conductor material	dimensions (mm)			min./mult. ord. qty (pcs)
					length L1	length internal L2	internal diameter D2	
CM2535	CMMT 25	25	12	Cu	38	17,5	7	1
CM3040	CMMT 35	35	12	Cu	44	23	9	1
CM0050	CMMT 50	50	12	Cu	48	25	10	1
CM7080	CMMT 70	70	12	Cu	53	30	12	1
CM9510	CMMT 95	95	12	Cu	60,5	34	13,7	1
CM0120	CMMT 120	120	12	Cu	63	38	15,2	1
CM0150	CMMT 150	150	12	Cu	70	42	16,7	1
CM0185	CMMT 185	185	12	Cu	83	48	19,2	1
CM0240	CMMT 240	240	14	Cu	93	53	21,2	1
CM0300	CMMT 300	300	14	Cu	94	59	23,7	1